

CENTARI® 600 BASECOAT LAQUER



PRODUCT DESCRIPTION

Centari 600 Basecoat mixes concentrated tints with solventborne binders to create a basecoat suitable for non-VOC compliant markets. It is suitable for spot, panel and overall repairs.

All-round solventborne refinishing performance

FEATURES

- 01** Provides easy, effortless and smooth application.
- 02** Provides coverage at low film thickness (10-20 μ).
- 03** Suitable for multi-tone striping and design work.
- 04** Has fast air drying option.
- 05** Provides exceptional aluminium flake control in metallics.
- 06** Delivers outstanding colour performance and extremely accurate colour matching.
- 07** For superior film properties, use with BK220.

TECHNICAL DATA SHEET

CENTARI® 600



BASECOAT LAQUER

Product preparation - application for 2-stage colours



It is strongly recommended to use appropriate personal protection equipment during application to avoid respiratory, skin and eye irritation.

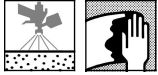

Old or original paintwork well sanded and cleaned
 Primer-surfacer or Surfacer, sanded and cleaned
 Primer-surfacer or Surfacer, unsanded in a wet-on-wet process
 Surfaces must be prepared and cleaned correctly before application
 Repair areas should be sanded with P500-P600 (by machine) or P800-P1000 (by hand) and cleaned



	15-25°C	20-30°C	>25°C	>30°C
	AB380 / XB383	AB385	XB387	XB390
			Chip Protector	Thinner
		C600	BK220	AB380 / AB385 / XB383 / XB387 / XB390
Standard	All colours	1	-	0.8
Standard Activated	All colours	0,9	0.1	0.8

Mixing ratio's are on volume.
 For superior film properties, the use of BK220 is recommended.



Activated: 8 hr



	Spray nozzle	Spray pressure	
Compliant	1.2 - 1.4 mm	1.8 - 2 bar	inlet pressure
HVLP	1.3 - 1.4 mm	0.7 bar	atomisation pressure

see manufacturer's instructions



2 coats with intermediate and final flash-off until flat



Clearcoat

VOC compliant

This product mix is not VOC compliant.

TECHNICAL DATA SHEET

CENTARI® 600



BASECOAT LAQUER

Centari Blend in Standard application

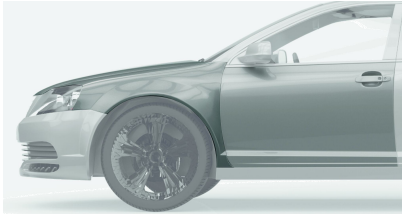

Adjacent panel:
sand panel with suitable abrasive e.g. Trizact - P1000
New part / repair: sand surfacer (minimum P500)

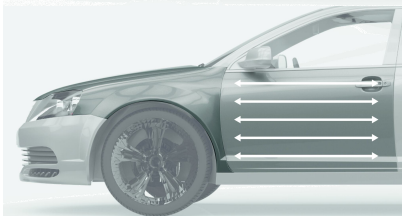

Apply the blender avoiding the extreme edges of the panel.
Remark: Blender can be wet or preferably dry.
Recommended to use slow thinners.
Note: Blender Centari 6000 XB165/XB Thinners - 3/1
Blender Centari 600 AB160/AB Thinners - 1/0.8

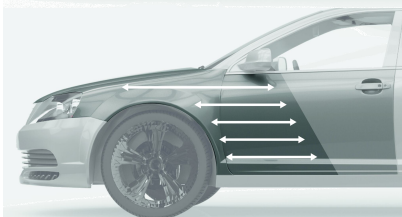

Apply the 1st coat of basecoat to the widest area on the complete repair and allow to dry.

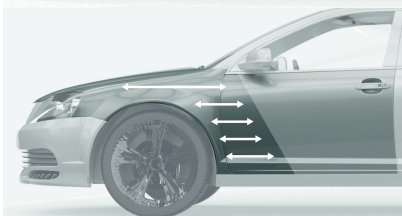

Spray the 2nd coat of basecoat inside the 1st coat on the complete repair and allow to dry.
Do not extend beyond the 1st coat.
Remark: Apply a mistcoat for metallics and pearls.

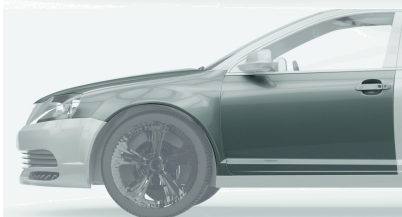

Apply clearcoat.
2% activation (AR075W) of all layers is a must using CC6700

10% activation (BK220) of all layers is a must when using CC6700.

TECHNICAL DATA SHEET

CENTARI® 600



BASECOAT LAQUER

Product preparation - application for Tri-stage colours



It is strongly recommended to use appropriate personal protection equipment during application to avoid respiratory, skin and eye irritation.

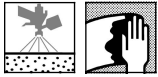

Old or original paintwork well sanded and cleaned
 Primer-surfacer or Surfacer, sanded and cleaned
 Surfaces must be prepared and cleaned correctly before application
 Repair areas should be sanded with P500-P600 (by machine) or P800-P1000 (by hand) and cleaned



	15-25°C	20-30°C	>25°C	>30°C
	AB380 / XB383	AB385	XB387	XB390
		C600	Chip Protector BK220	Thinner AB380 / AB385 / XB383 / XB387 / XB390
Ground coat (Activated)	All colours	0,9	0.1	0.8
Standard	All colours	1	-	0.8

Mixing ratio's are on volume.
 For superior film properties, the use of BK220 is recommended.



Activated: 8 hr



	Spray nozzle	Spray pressure	
Compliant	1.2 - 1.4 mm	1.8 - 2 bar	inlet pressure
HVLP	1.3 - 1.4 mm	0.7 bar	atomisation pressure

see manufacturer's instructions



2 coats ground coat with intermediate and final flash-off until flat
 2 coats effect/midcoat with intermediate and final flash-off until flat



Clearcoat

VOC compliant

This product mix is not VOC compliant.

TECHNICAL DATA SHEET

CENTARI® 600



BASECOAT LAQUER

Centari Blend in Tri-stage application

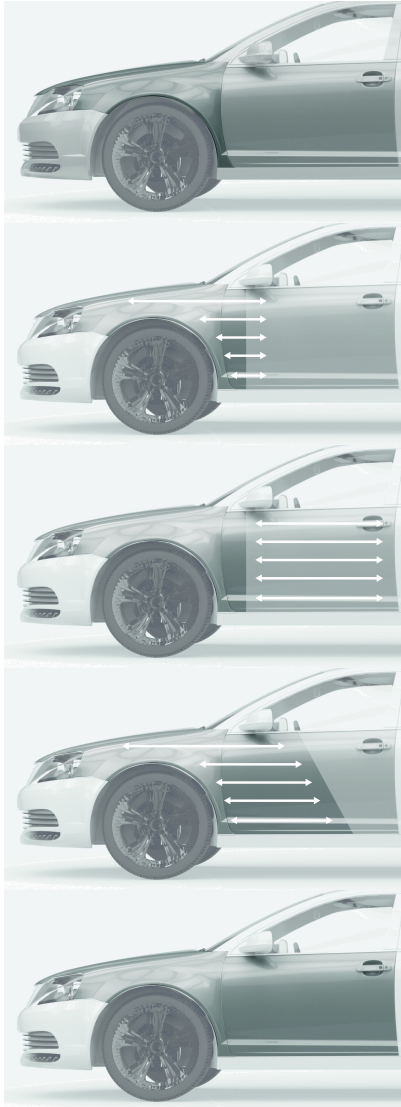

Adjacent panel:
sand panel with suitable abrasive e.g. Trizact - P1000
New part / repair: sand surfacer (minimum P500)

Apply the activated Ground coat until full hiding is achieved on the repair area. Extend into fade out area and allow to dry in between coats and before effect colour.

Note: Mixing colour / BK220 / thinner :
C600: 0.9/0.1/0.8
C6000: 2.7/0.3/1

Apply a closed coat of Centari blender to adjacent blending area.

Remark: blender can be wet or preferably dry.

Recommended to use slow thinners.

Note: Blender C6000: XB165/XB-Thinners - 3/1
Blender C600: AB160/AB-Thinner - 1/0.8

Apply the required amount of effect coats followed by a light coat, fading out into the blender.

Apply clearcoat to finish the repair.

10% activation (BK220) of all layers is a must when using CC6700.

TECHNICAL DATA SHEET

CENTARI® 600



BASECOAT LAQUER

Product preparation - application with Centari Basecoat Activated (BK220)



It is strongly recommended to use appropriate personal protection equipment during application to avoid respiratory, skin and eye irritation.

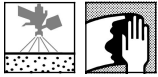

Old or original paintwork well sanded and cleaned
 Primer-surfacer or Surfacer, sanded and cleaned
 Primer-surfacer or Surfacer, unsanded in a wet-on-wet process
 Surfaces must be prepared and cleaned correctly before application
 Repair areas should be sanded with P500-P600 (by machine) or P800-P1000 (by hand) and cleaned



	15-25°C	20-30°C	>25°C	>30°C	
	AB380 / XB383	AB385	XB387	XB390	
			Blender	Chip Protector	Thinner
		C600	AB160	BK220	AB380 / AB385 / XB383 / XB387 / XB390
For use under CC6700	All colours	0,9	-	0.1	0.8
	Blending	-	0,9	0.1	1
Multi-toning	All colours	0,9	-	0.1	0.8

Mixing ratio's are on volume.
 For superior film properties, the use of BK220 is recommended.
 For Tri-stage colours 10% activation (BK220) of all layers according above specifications is a must when using CC6700.
 For multi-toning every layer but the last one needs to be activated, except for use under CC6700 all layers need to be activated.



Activated: 8 hr



	Spray nozzle	Spray pressure	
Compliant	1.2 - 1.4 mm	1.8 - 2 bar	inlet pressure
HVLP	1.3 - 1.4 mm	0.7 bar	atomisation pressure

see manufacturer's instructions



2 coats	with intermediate flash-off: 1 min - 2 min Till flat between coats for transparent and bright colours flash-off until flat before clearcoating
2 coats ground coat	with intermediate flash-off: 1 min - 2 min Till flat between coats for transparent and bright colours flash-off until flat before clearcoating
2 coats effect/midcoat	with intermediate flash-off: 1 min - 2 min Till flat between coats for transparent and bright colours flash-off until flat before clearcoating



Clearcoat

VOC compliant

This product mix is not VOC compliant.

TECHNICAL DATA SHEET

CENTARI® 600

BASECOAT LAQUER



Products

Centari® 600 Basecoat Lacquer

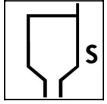

DIN 4: 15 - 16 s at 20°C



10 - 20 µm



Clean after use with a suitable solventbased guncleaner.

Remarks

- Material has to be at room temperature (18-25°C) before use.
- Centari MasterTints have to be thoroughly mixed before weigh-out and the Centari colour has to be mixed immediately after weigh-out.
- On well prepared surface, apply 2 full coats and flash till flat between coats. Spray a mistcoat 1-2 min after last coat if needed.
- Addition of 10% BK220 Basecoat Chip Protector before dilution is recommended. It also gives increased quality features, improved stone chip resistance and superior adhesion cohesion.
- For Tri-stage colours we advise to activate the Ground coat with 10% BK220 Basecoat Chip Protector.
- Maximum time before clearcoating is 3 days.

Consult Safety Data Sheet prior to use. Observe the precautionary notices displayed on the container.

All other products referred to in the refinish build up are from our Cromax product range. System properties will not be valid when the related material is used in combination with any other materials or additives which are not part of our Cromax product range, unless explicitly indicated otherwise.

For professional use only! The information provided in this documentation has been carefully selected and arranged by us. It is based upon our best knowledge on the subject at the date of issuance. The Information is given for information purposes only. We are not liable for its correctness, accuracy and completeness. It is up to the user to check the information with regard to up-to-dateness and suitability for his intended purpose. The intellectual property in this Information, including patents, trademarks and copyrights, is protected. All rights reserved. The relevant Material Safety Data Sheet and Warnings displayed on the product label need to be observed. We may modify and/ or discontinue operation of all or portions of this Information at any time in our sole discretion, without notice and assume no responsibility to update the Information. All rules set forth in this clause shall apply accordingly for any future changes and amendments.